

[illegible]

**PRELIMINARY PLAN
NOT FOR CONSTRUCTION**
THESE PLANS ARE NOT FULLY PERMITTED
AND ARE SUBJECT TO REVISIONS MADE
DURING THE PERMITTING PROCESS.
RESPONSIBILITY FOR THE USE OF THESE
PLANS PRIOR TO OBTAINING PERMITS FROM
ALL AGENCIES HAVING JURISDICTION OVER
THE PROJECT WILL FALL SOLELY UPON THE
USER.

ISSUE DATE:	02/25/2026
-------------	------------

DESIGNED BY: CA

DRAWN BY: BN

CHECKED BY: CA

BID-CONTRACT:	
----------------------	--

CHRISTOPHER T. ANDREONI, P.E.
FLORIDA REG. NO. 84184
(FOR THE FIRM)

CLIENT

**RP
POMPANO
LLC**

PROJECT	
---------	--

**DOWNTOWN
POMPANO -
PHASE 1 -
INFRASTRUCTURE
IMPROVEMENTS**

SHEET TITLE

WATER AND SEWER PLAN

**SHEET
NUMBER** **CU-103**

PROJECT NUMBER	15083.00
-------------------	----------

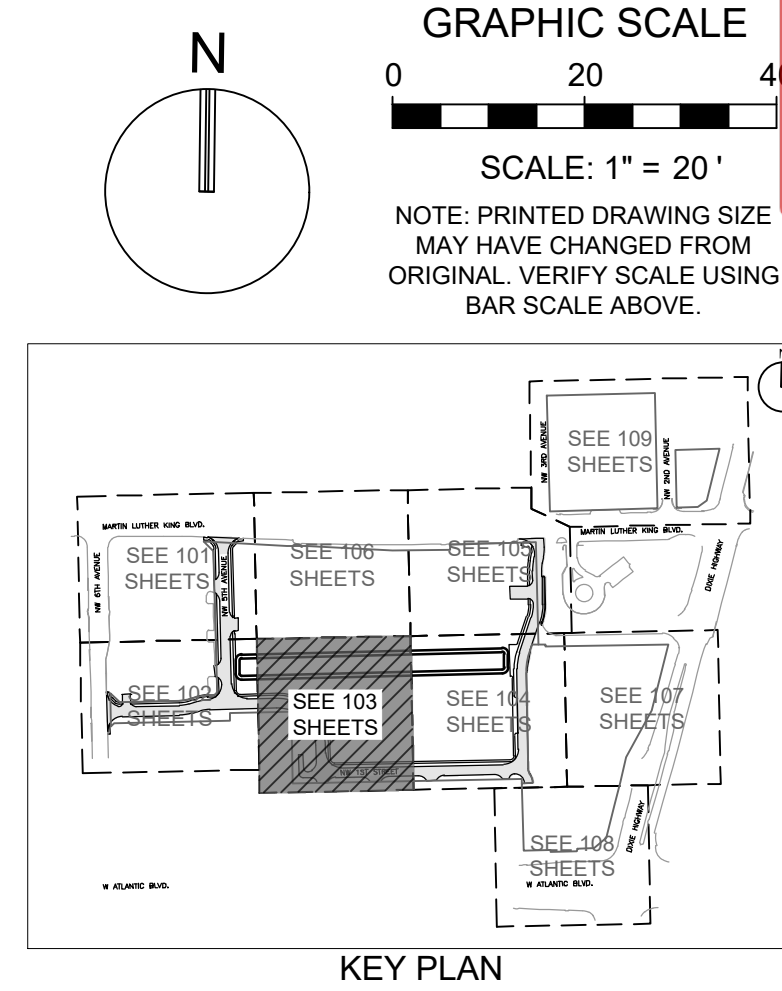

NOTES

1. ANY EXISTING WATER AND/OR SEWER CONNECTION TO THE SUBJECT LOTS NOT UTILIZED MUST BE CUT AND CAPPED AT THE WATER MAIN IF A WATER SERVICE, AND CUT OUT AND SLEEVED IF A SEWER LATERAL.
2. CONTRACTOR TO FIELD VERIFY SIZE OF EXISTING WATER SERVICES WHEN CUTTING AND CONNECTING PROPOSED WATER SERVICES.
3. IF CORE-DRILLING INTO AN EXISTING MANHOLE, THE CONTRACTOR SHALL RECONSTRUCT MANHOLE FLOW CHANNELS AND BENCHES AND RECOAT COMPLETE MANHOLE WITH CITY APPROVED COATING SUCH AS "SEWER COAT" OR APPROVED EQUAL IN ACCORDANCE WITH CITY STANDARDS.
4. HOW TO RETIRE OLD SEWER LATERALS:
 - a. IF THE EXISTING MAIN IS CLAY PIPE AND HAS A CIPP LINER CURRENTLY INSTALLED, INSTALL A SECTIONAL LINER IN THE MAIN OVER THE OLD LATERAL THUS ELIMINATING THE LATERAL.
 - b. IF THE EXISTING MAIN IS CLAY PIPE, DIG DOWN CUT OLD CLAY PIPE, SLEEVE BACK WITH PVC AND CITY APPROVED COUPLINGS
 - c. IF THE EXISTING MAIN IS CLAY PIPE AND THE PROJECT REQUIRES TO RETIRE MULTIPLE LATERALS, IT MAY BE CHEAPER FOR THE CONTRACTOR TO INSTALL A CITY APPROVED CIPP LINER FROM MANHOLE TO MANHOLE AND NOT CUT OUT THE LATERALS THAT THEY ARE RETIRING.
 - d. IF THE EXISTING MAIN IS PVC PIPE, REMOVE THE LATERAL PIPE FROM THE PVC WYE FITTING AND INSTALL A PLUG INTO THE WYE. INSTALL A GREEN LOCATION MARKING BALL AT THE LATERAL LOCATION, NO DEEPER THAN 4' BELOW GRADE.
4. THE CONTRACTOR SHALL PROVIDE SIGNAGE TO DIRECT PEDESTRIAN TRAFFIC DURING CONSTRUCTION, REMODELING AND DEMOLITION ACTIVITIES PER FBC 3306.1.

MATCH LINE: REF. SHEET CU-106

MATCH LINE: REF. SHEET CU-102

MATCH LINE: REF. SHEET CU-104

Drawing name: H:\15083.00 - DOWNTOWN POMANO - RP Development LLC\Engineering\Cadd\Phase 1\Infrastructure\1\15083.00-CL-1XX-PH1.dwg

STATIIS: DPEI IMINAPV